

# vw heritage



KARMANN GHIA 1956 - 1974, CATALOGUE 2015 ISSUE 2



[WWW.VWHERITAGE.COM](http://WWW.VWHERITAGE.COM)

# vwheritage



## The Karmann Ghia – We still believe!

The Karmann Ghia celebrated its 60th anniversary in 2015 and to celebrate this occasion we decided to reinstate our catalogue, after 3 years out of circulation.

We re-launched the catalogue at the 2015 Volksworld show, where we also arranged the first ever UK appearance of the 1953 Karmann Ghia prototype. The display was such a success that by September we'd run out of catalogues and after such a positive response, it only seemed right to improve and re-print! So here is issue 2.

Whilst there are far fewer Karmann Ghias on the road in comparison to Beetles, we still truly believe in supporting the enthusiasts who own this wonderful vehicle. Whether you have owned one for years, or are just starting out on a project, we'd like to thank you for keeping Volkswagen's most stylish car alive.

We'd love to write here that we can supply every part you need for your Karmann Ghia, but sadly that is impossible. What we can offer you is the best range of new parts for your vehicle anywhere in the world. Whether you are looking for body trim, electrical, interior, glass, or rubber seals, our quality is the best available and our service second to none.

Many of you know David personally. He founded VW Heritage in 1986, and has steered us to where we are now with great skill and enthusiasm. As of September 2015 he has taken up position as Chairman and I have stepped into his role as Managing Director. Don't panic, there will be no big changes; I've worked at VW Heritage for 12 years as Sales Director, and my ethos and values are very much aligned with those of David's.

If this is your first contact with VW Heritage, then welcome from me. A big hello if you are an existing friend and customer, we look forward to helping you again.

Speak soon

Barney Dines.  
Managing Director

\*see website for full terms and conditions

**ORDER BY PHONE:**  
**01273 444 000**

**ORDER ONLINE:**  
**VWHERITAGE.COM**

**FREE UK DELIVERY ON:**  
**INTERNET ORDERS\***

\*On orders over £35. Terms and Conditions apply, please see [www.vwheritage.com](http://www.vwheritage.com) for details.

BODY	7
INTERIOR	12
CABRIOLET	16
ELECTRICAL	17
COLOUR SWATCHES	19



Mechanical parts are illustrated in our free Beetle catalogue and on our website. Call us for a copy, or download online



A full list of our terms and conditions of sale are available on request. All pictures and drawings in this catalogue are general and may not relate to a specific part. © October 2015 By VW Heritage Parts Centre Ltd. No part of this catalogue may be reproduced without written permission from VW Heritage. Street Style And Power & VW Heritage are trading names of VW Heritage Parts Centre Limited. Registered in England & Wales. Company No.3294341. VAT Number GB 475 7671 01. E. & O.E. All offers/prices are subject to change without prior notice and can be changed at any time.



THOUSANDS OF CLASSIC AND PERFORMANCE PARTS FROM THE VW EXPERTS

WHY USE US?

VW Heritage is run by enthusiasts who live and breathe VWs. It's what makes us what we are; Parts Specialists. Got a question? Chances are one of us has asked it too, and now we know the answer! Our warehouse is full with more than 17,000 lines; we should be able to help no matter what your part requirements are.

PRICED TO SELL

£ We strive to have the most competitive prices out there – if you've seen it somewhere cheaper we will aim to beat it... and if we can't it probably means ours is better! All prices include VAT at 20%.

THAT'S NOT RIGHT

? Got a washer when you needed a window? Give us a call and we will get on it straight away. Be it a supplier error or just a plain human mistake, we will do our best to rectify all issues within 24 hours.

ERMM, IT SHOULDN'T BE LIKE THIS?

☒ So an elephant's sat on the box? Please, please have a look in it now. Check the contents of every order, if there's a problem to sort we need to know ASAP.

QUALITY PARTS

⚙️ All parts are sold with at least a standard one year warranty (excluding a few specific items) As much as we would love to say nothing ever breaks – it does happen, so give us a call and we will make sure it gets sorted. Let us have a look too, a picture speaks a thousand words.

DIDN'T NEED THAT BIT AFTER ALL

↩️ Our 30 Day no quibble returns policy is simple. Complete the form on our website or give us a call and we will give you a specific returns number for the unwanted items. Had the part longer? Parts can be returned up to 90 days, subject to a 20% handling charge. See terms and conditions for full details. - www.vwheritage.com/returns

COME ON DOWN

🏠 Our doors are open 9am to 5.30pm in the week and 10am to 4pm on a Saturday. If you are making the journey for a specific part why not call us first, we can get it reserved on an order for you so it doesn't sell in the meantime.

SO WHAT NOW

💻 You can order online at www.vwheritage.com from the comfort of your own living room, and with free carriage available on most orders over £35 it's almost too easy! If you have a question, how about calling our mail order hotline 01273 444 000. We can offer you the advice you need, and if you order before 3pm we can usually get your parts to you by the next working day!

PAYMENT

💳 We accept the following forms of payment:  
 Cash - Shop customers only • Credit/Debit Card - Visa, Mastercard  
 • Bank Transfer by arrangement • Paypal

CARRIAGE COSTS

We operate a fast and efficient mail order system.

Delivery prices are shown in the table and include VAT @ 20%. Exports outside Europe are priced individually.

All goods sent by ourselves are fully insured against loss and damage. We make sure you get your parts in perfect condition wherever you are.

On receipt of your parcel, always check the goods before signing. If there are any damaged, missing or incorrect parts we need to know within one working day of delivery. This will enable us to sort out any problem quickly!

**A = Normal Orders**

**B = Glass, Panels, Front Axles & Bumpers**

**C = Engines, Gearboxes, Complete Bus Front Panels & Bonnets**

Glass - Mail orders containing glass require special packaging (this is an additional charge). This will be refunded if the packaging is returned.

UK Mainland, Scottish Highlands, & Isle Of Wight			
Order Value	A	B	C
Up to £19.99	£4.00	£8.00	£40.00
£20.00 - £74.99	£6.50	£10.00	£40.00
£75+	£9.50	£16.50	£40.00

Scottish Islands, Northern Ireland, Channel Islands, Scilly Isles & Isle of Man			
Order Value	A	B	C
Up to £19.99	£4.00	£15.50	£80.00
£20.00 - £74.99	£9.50	£17.50	£80.00
£75+	£12.50	£22.50	£80.00

Eire, Belgium, Luxembourg, Germany & France			
Order Value	A	B	C
Up to £19.99	£8.00	£22.50	£80.00
£20.00 - £74.99	£13.50	£31.00	£80.00
£75+	£20.00	£35.00	£80.00

All other European & Worldwide destinations - please call our sales team for a quote.



'Buy With Confidence' Approved Member

VW Heritage Parts Centre Ltd. is an Approved Member of Trading Standards' Buy With Confidence scheme. This means that we have been audited and approved by West Sussex County Council Trading Standards to provide a reliable and quality service. See our website for more details.



# RUN BY ENTHUSIASTS, FOR ENTHUSIASTS

This is a snapshot of the VWs currently owned by some of our staff at VW Heritage.

Because we are VW owners and drivers, we understand why quality is important and with our many collective years of experience owning and working on VWs, we will help you

through your restoration or repair job with technical advice and, most importantly, by supplying the right parts on time.



**David - Chairman**  
'83 Mk1 Golf, 1100cc 28,000 miles from new, completely standard



**Barney - Managing Director**  
VW Heritage hand built Mexican Beetle, 1600cc, Donau rally livery



**Gary - Ebay Sales**  
'58 "low light" Ghia, twin carb 30hp engine. 356 style wheels, black VW Heritage carpets



**Mark - Operations Director.** '99 T4 Caravelle, lowered, 16" Borbet B alloys, bonnet bra, leather seats



**Nick - Sales Manager.** '62 US Spec Beetle, original Gulf Blue paintwork, rag top, SSP BRM's



**Jeff - Sales Director**  
'66 Beetle, Sea Sand, 1300cc



**Anna - Product Manager**  
'90 MK2 VR6 with BBS RM wheels and Rallye front end



**Andy G - Marketing Manager**  
'76 Polo L, lowered 60mm, 15" Fooks alloys, rebuilt 895cc, full body resto



**Aurelie - Trade Sales**  
'67 Split, ex Swiss ambulance 1776cc CSP Python exhaust, SSP Fooks



**James T - Trade Sales**  
'66 Beetle, Sea Blue, 1641cc homebuilt turbo motor, Gasburners



**Dave - Web and I.T**  
'65 Beetle, SSP GT5s, narrowed beam, TMI Interior, 1600cc



**Christian - Returns**  
'91 MK2 Golf GTI, lowered, Porsche Design 90's



**Richard Davies - US Sales Manager**  
'65 Beetle, 240bhp Type 4 engine, Porsche 5 speed gearbox, 17" wheels and brakes



**Alex T - Sales Administration**  
white '65 Beetle, 1600cc



**Alex - Aircooled Product Manager**  
'69 Delux, Cali Import, 2276cc, FK10, 48 IDFs, Line Loc, Built 091 G/Box



**Laurent - Trade Sales Manager**  
Type 3 Fastback DIY restoration, repaint in Savannah Beige, 1641cc motor



**Tara - Purchasing Coordinator**  
'72 Beetle, fully restored, 1600cc, silver Empi 8s



**James D - Web Content Manager**  
'58 Karmann Kafer Kabriolett



**Will - Graphic Designer**  
'73 Beetle, lowered at the front, original 1200cc engine



**Ben - Market Analyst**  
'69 Deluxe, original paint, 2109cc Type 1 motor

# VW CLASSIC PARTS COULD BE THE ANSWER TO YOUR PRAYERS!

Our partnership with VW Classic Parts is helping enthusiasts all over the UK to track down those missing pieces for their projects from the very source that the parts came from in the first place!



Whether it is a single screw or a side panel, a headlamp or a hose, VW Classic Parts could have that elusive part you require. Having collected over 40,000 parts of obsolete stock from warehouses and dealerships around the globe this is a fantastic resource for us to be able to share with you.

David Ward, founder of VW Heritage explains the importance of this partnership to VW Heritage and the UK VW community.

***“Since starting out in the early eighties we have travelled full circle. We are still supplying hard to find and obsolete genuine parts for Beetles and other classic Volkswagen models, just now they come shipped direct from Wolfsburg –not collected by me from a German VW dealer in the family Camper!***

***This is such great news for VW enthusiasts in the UK, it's real proof that VW care about their heritage and are in full support of the UK Volkswagen scene.”***

Volkswagen haven't just drawn a line in the sand to define their classic cars, it is a rolling cut off which means even the T4 van is now classed as a classic! So we can help you get genuine parts for it, even if the main dealer can't.

Carsten Thrandorf, International Sales Director at VW Classic Parts has reinforced his commitment to VW Heritage with some great news.

***“We are expecting to reproduce 500 original parts in the next 5 years, and we firmly believe our partnership with VW Heritage will go a long way to making sure these are the “right parts” to manufacture, and that they are available to the enthusiasts who really need them.***

***In VW Heritage we have found a company with over 25 years experience and a strong team of knowledgeable enthusiasts who are able to offer the level of service that is expected by existing and new customers of the VW brand. We can only look forward with anticipation and excitement to the future of this partnership.”***



CHECK CURRENT PRICES ONLINE  
**VWHERITAGE.COM**

# UNDERSTANDING YOUR KARMANN GHIA

If you're lucky enough to own one of the ½ million Karmann Ghias ever produced then congratulations. Your car, and indeed each and every one is very special, and arguably one of the most beautiful cars ever made.

The Karmann Ghia was the brainchild of Wilhelm Karmann Jnr. His father, Wilhelm Snr. founded Karmann Karosserie, and was responsible for the production of the VW Beetle Cabriolet at their Osnabruck based factories. He sadly passed away, but left the company in very safe hands.

Despite Volkswagen's lack of interest Wilhelm enlisted Carozzeria Ghia of Turin to produce a prototype sports car, built upon the already familiar Type 1 chassis; it was his hope that with a fully functional design study he would win over VW CEO Heinz Nordhoff and secure the future of his dream.

With the Beetle chassis widened, and a hand built coupe body bolted on, (not a sleek spyder as original specified) the prototype was unveiled in a private garage in Paris. VW were so impressed by the design, that they signed it off for production in 1953. However it didn't go on sale for another 18 months due to production and process refinements stipulated by Volkswagen.

Although the 1955 production version of the car differs slightly from the prototype with nostril vents added and the engine lid and exhausts changed, the car remained very true to its original concept.

The earliest of examples made between '55 and 1959 are called 'Lowlight' models; and sport smaller nostrils, smaller tail lamps, and of course head lamps mounted lower down on the front panel. In 1957, the Karmann Ghia cabriolet was released to the public; once again developed behind closed doors, then shown to VW for approval and commission afterwards.

The biggest change came in 1960, with a facelift. Headlights were moved higher and the ventilation nostrils grew bigger. In 1961 the Type34 "Razoredge" Karmann Ghia was launched, which was intended as a larger and more luxurious sister model to the Type14. These were never as popular as the original design and production ended in 1969. Whilst we don't offer many parts for these cars, we are most appreciative of its distinctive design.

Between '62 and '69 the Type14 was also manufactured in Brazil. In total 23,500 cars were produced there, although only 177 of the cars sold were cabriolets. The Karmann Ghia TC replaced it from 1970 -76.

Cosmetically little changed throughout production, front indicators and rear lights got bigger in 1970, and the rounded bumpers were swapped for the larger 'Europa' style in 1971 to conform to US crash testing standards. This style remained until 1974 which saw the end of German production.

The Type14 shares its engine, gearbox, steering, braking and suspension with the Beetle that was produced in the same year. For this reason our catalogue contains only the specific parts for the 'Ghia. For all other components please refer to our VW Beetle catalogue.

## CHASSIS NUMBERS

Produced	Year	Chassis no. from	To
AUG 1955	56	929746	1 600 439
AUG 1957	58	1 600 440	2 528 667
AUG 1959	60	2 528 668	3 192 506
AUG 1960	61	3 192 507	4 010 994
AUG 1961	62	4 010 995	4 846 836
AUG 1962	63	4 846 836	5 677 118
AUG 1963	64	5 677 119	145 000 000
AUG 1964	65	145 000 001	146 000 000
AUG 1965	66	146 000 001	147 000 000
AUG 1966	67	147 000 001	148 000 000
AUG 1967	68	148 000 001	149 000 000
AUG 1968	69	149 000 001	140 2000 000
AUG 1969	70	140 2000 001	141 2000 000
AUG1970	71	141 2000 001	142 2000 000
AUG 1971	72	142 2000 001	143 2000 000
AUG 1972	73	143 2000 001	144 2000 000
AUG 1973	74	144 2000 001	144 2999 000



BODY PANELS

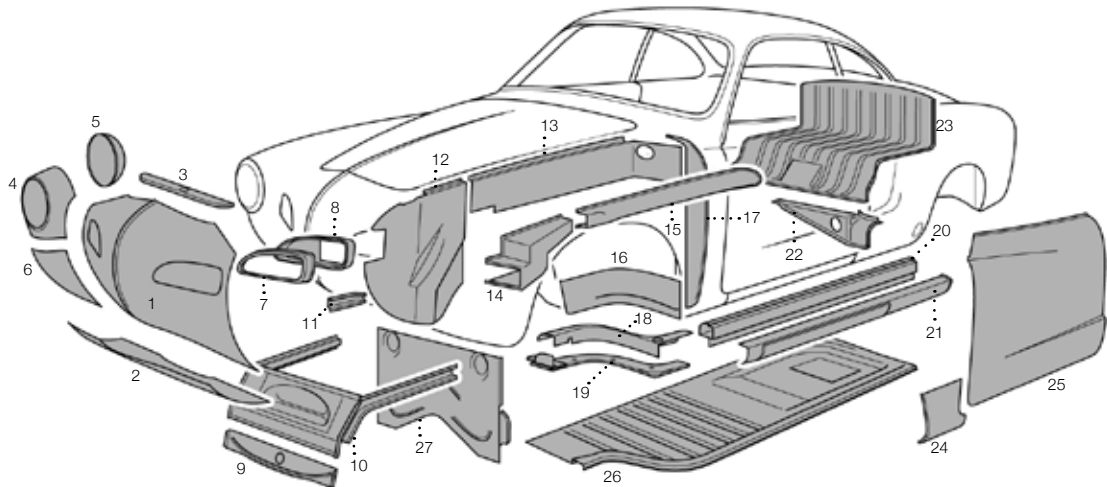

<b>1</b>	<b>Nose panel</b> , an excellent pressing, nostrils will need to be cut out. Not supplied with air boxes.	141-805-065/DV
<b>2</b>	<b>Front lower repair panel/spare wheel well bottom.</b>	141-404-000
<b>3</b>	<b>Bonnet slam panel.</b>	141-805-065
<b>4</b>	<b>Headlight repair panel</b> , upper, 1960-74 Left Right	141-404-211 141-404-212
<b>5</b>	<b>Headlight bowl</b> , 1960-74	141-809-145/C
<b>6</b>	<b>Headlight repair panel</b> , lower Left, 1960-69 Right, 1960-69 Left, 1970-74 Right, 1970-74	141-809-107/B 141-809-108/B 141-809-107/D 141-809-108/D
<b>7</b>	<b>Fresh air box</b> , outer Left, 1960-74 Right, 1960-74	141-404-053 141-404-054
<b>8</b>	<b>Fresh air box</b> , inner Left, 1960-74 Right, 1960-74	141-404-051 141-404-052
<b>9</b>	<b>Spare wheel well</b> , lower rear upright section.	141-404-233
<b>10</b>	<b>Reinforcement panel</b> , spare wheel well back and fuel tank supports. Needs modification to the lower part to fit a KG.	113-805-505/CR
	<b>Washer bottle recess panel</b> , 1962-	113-805-508
	<b>Cover plate</b> , central spare wheel well.	111-805-589
	<b>Cover plate</b> , steering box adjustment. 1961-	111-805-585/A
<b>11</b>	<b>Front bumper mount</b> , for blade bumpers, left or right. 1956-70	111-809-131
<b>12</b>	<b>Front inner wing section.</b> Left, 1956-74 Right, 1956-74	141-404-101 141-404-102
<b>13</b>	<b>Upper inner wing section.</b> Left, 1956-74 Right, 1956-74	141-404-111 141-404-112
<b>14</b>	<b>Front fresh air ducts</b> , welds to front inner wing. Left, 1960-74 Right, 1960-74	141-805-083 141-805-084
<b>15</b>	<b>Rear fresh air ducts</b> , welds to upper inner wings. Left, 1960-74 Right, 1960-74	141-404-121 141-404-122
<b>16</b>	<b>Front inner wing</b> , lower rear repair section, welds to the forward part of the heater channel. Left, 1956-74 Right, 1956-74	141-404-381 141-404-382
<b>17</b>	<b>Splash panels.</b> Stops dirt and water from getting up behind the A pillar. Screws in place. Left, 1956-74 Right, 1956-74	143-805-377/A 143-805-378/A
	<b>Seal for splash panels.</b>	143-805-375
<b>18</b>	<b>Heater channel front section</b> , upper. Left, 1956-74 Right, 1956-74	141-404-131 141-404-132
<b>19</b>	<b>Heater channel front section</b> , bottom plate. Left, 1956-74 Right, 1956-74	141-404-133 141-404-134

<b>20</b>	<b>Heater channels.</b> Left, 1956-74 Right, 1956-74	141-801-045/D 141-801-046/D
	<b>Inner sill strengthener</b> , cabrio, left or right.	141-801-108
<b>21</b>	<b>Sills.</b> Outer skins of the heater channel. Partially visible below the door. Left, 1956-74 Right, 1956-74	141-404-421 141-404-421
<b>22</b>	<b>Rear cross members</b> , the panels that bolt to the edge of the floorpan. Left, 1964- Right, 1964-	111-801-201/AD 111-801-202/AD
	<b>Rear cross member repair plate</b> , left, 1956-74	111-801-203/VNG
	<b>Rear cross member repair plate</b> , right, 1956-74	111-801-204/VNG
<b>23</b>	<b>Boot floor</b> , fits between the rear wheel wells, above the gearbox. Will need the top edge trimming to fit a KG.	131-813-111/BH
	<b>Boot floor side repair</b> , left, 1956-74	113-813-101
	<b>Boot floor side repair</b> , right, 1956-74	113-813-101
<b>24</b>	<b>Front wing repair</b> , lower, rear. Left, 1960-74 Right, 1960-74	141-404-221 141-404-222
	<b>Fuel filler recess on front wing.</b>	141-404-200
<b>25</b>	<b>Door skin</b> , outer. Designed for use with the 72-74 door top trim with integral window scraper. If using on 68-72 you will need to change to the later trim and scraper. Pre '68 cars have a different door handle, you either need to modify the panel or change the door hardware. Left Right	141-831-101 141-831-102
	<b>Hinge</b> , Upper left	141-831-401/C
	<b>Hinge</b> , Upper right	141-831-402/C
	<b>Hinge</b> , Lower Left	141-831-411/D
	<b>Hinge</b> , Lower Right	141-831-412/D
	<b>Screw set for hinges.</b>	N10084701SET
<b>26</b>	<b>Floorpan halves.</b> Left, 1956-74 Right, 1956-74	141-701-061 141-701-062
	<b>Accelerator pedal mount.</b> Welds to floorpan.	111-701-535/A
	<b>Floor plate</b> , supports the back edge of the floorpan. Will need a small extension piece added to use on the KG. Left, 1956-74 Right, 1956-74	111-801-203/D 111-801-204/D
<b>27</b>	<b>Cross panel</b> , Genuine, LHD, 1961- <b>Lower cross panel</b> , double skinned, short repair panel, fits 1961- <b>Lower cross panel</b> , double skinned, tall repair panel, fits 1961-	113-805-451/F 111-805-452 111-805-451/AR
	<b>Frame heads - Link pin axle.</b> Frame head, for link pin axle, up to 1965. Frame head, for link pin axle, up to 1965. Brazilian. Cover, for frame head access tunnel up to 1965.	113-701-037/G 113-701-111/B 113-701-565/A
	<b>Frame heads - Ball joint axle.</b> Frame head for ball joint axle, Brazilian 1966- Frame head for ball joint axle, inc. front crossmember, Brazilian, 1966- Frame head bottom plate for ball joint axle, 1966- Cover for frame head access tunnel, 1966-	113-701-037/L 113-701-037/XL 113-701-311/B 131-701-565
	<b>Front crossmember</b> , "napoleons hat", LHD, fits over the tunnel, carries the brake master cylinder. 1955-	113-701-131



REAR BODY PANELS

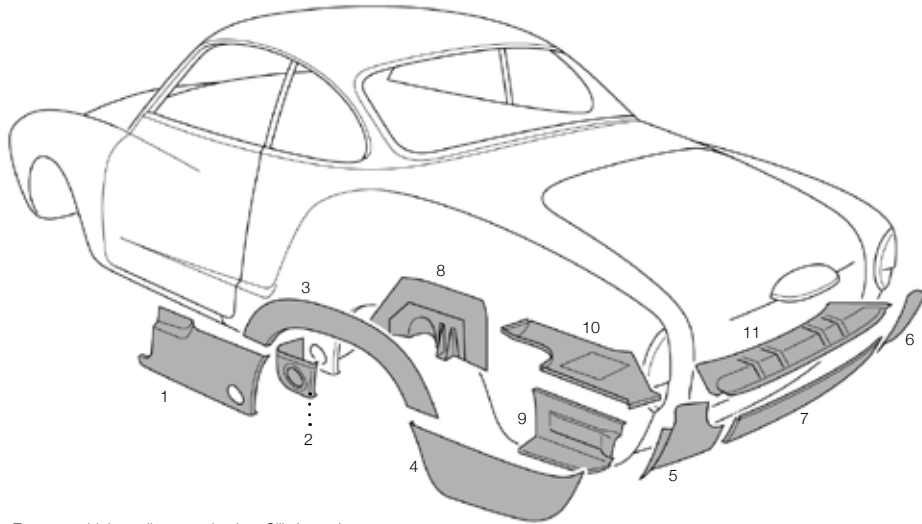

Quality

Most panels available are European high quality reproduction. Sills have the exact pressing including jacking point cut out/pressing and water drain outlets.

Obsolete Parts

If you cannot see the part you need in this catalogue, call us, and we will do our best to find it for you.

1	<b>Rear wing repair</b> , lower edge, in front of the wheel arch. Left, 1956-74 Right, 1956-74	141-404-501 141-404-502
2	<b>Inner wheel arch repair</b> , the front, lower, outer part of the inner wheel arch, behind the inspection hole. Left, 1956-74 Right, 1956-74	141-404-501 141-404-502
3	<b>Outer wheel arch repair panel</b> , Fits both sides	141-404-510
4	<b>Rear wing repair</b> , lower edge, behind the wheel arch. Left, 1956-71 Right, 1956-71 Left, 1972-74 Right, 1972-74	141-404-531 141-404-532 141-404-521 141-404-522

5	<b>Rear wing repair</b> , lower rear edge/rear valance, left, 1956-74	141-404-611
6	<b>Rear wing repair</b> , lower rear edge/rear valance, right, 1956-74	141-404-612
7	<b>Rear valance/apron</b> , 1956-74	141-404-600
8	<b>Rear quarter reinforcement</b> , body mount panels Left, 1956-66 Right, 1956-66 Left, 1967-74, with Z-bar mountings. Right, 1967-74, with Z-bar mountings.	113-809-171 113-809-172 113-809-171/A 113-809-172/A
9	<b>Bumper mounting panels</b> , 1956-74 Left Right Additional panel required for Euro bumpers. Mounts onto the above panels.	141-404-491 141-404-492 141-404-972
10	<b>Left hand engine bay side panel</b> , with channel for engine seal.	141-813-161/D
11	<b>Rear engine bay panel</b> , with channel for engine seal.	141-813-600

BUMPERS, IRONS & SEALS

<b>Bumpers, stainless steel european style.</b> 6 pieces per set (does not include bumper overrides).		
	56-66, Front & rear set	143 798 104
	67-69, Front & rear set	143 798 105
	70-71, Front & rear set	143 798 106
<b>Bumpers, stainless steel, us style includes overrides</b>		
	56-66, Front & rear set	143 798 101
	67-69, Front & rear set	143 798 102
	70-71, Front & rear set	143 798 103
1	<b>Bumper bolt</b> , 15mm, 60-71	113 707 191 C
2	<b>Bumper bolt</b> , 15mm, europa 72-74	113 707 191 C
3	<b>Bumper iron</b> Front, 60-71, left or right Rear, 56-71, left Rear, 56-71, right Front, 72-74, left or right Rear, 72-74, left or right	141 707 135 B 141 707 335 A 141 707 336 A 141 707 135 C 141 707 335 B
4	<b>Bumper iron seal</b> Set (4 pcs) 56-71 Front 72-74	111 707 197 A 01C 111 707 197 B
5	<b>Base seals</b> , pair 56-71	141 707 299 A
6	<b>Towel rail to bumper blade base seals</b> Front, pair, 58-69, rear 70-71 Rear, pair, 58-69	141 707 181 141 707 387
7	<b>Override seal set</b> , (inc 8 seals) 56-71	141 707 241 B
8	<b>Bumper iron cover seal set</b> (4 pcs) 56-71	141 707 251 A
9	<b>Bumper corner mounts</b> , front 56-71	141 707 300
10	<b>Bumper corner mounts</b> , rear 56-71	141 707 353
	<b>Bumper iron seal</b> , LH, front, US spec	141-807-137/DL
	<b>Bumper iron seal</b> , RH, front, US spec	141-807-138/DR

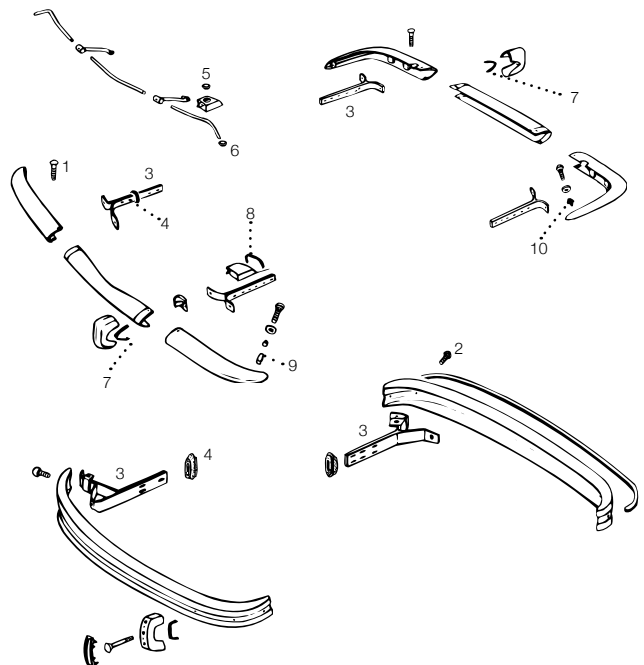



SIDE WINDOW SEALS & FITTINGS

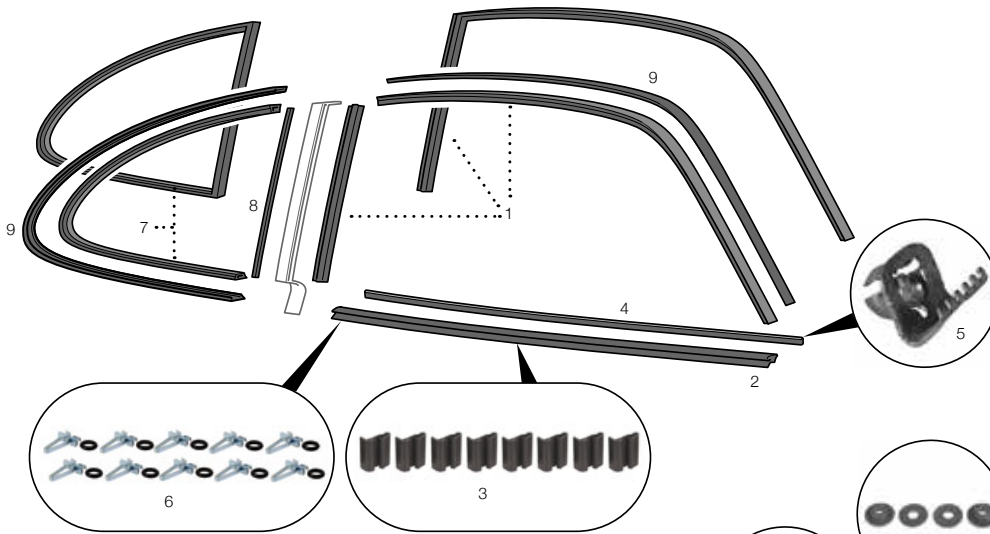

<b>1 Door glass top seals</b> 4 pieces 56-59 4 pieces 60-67 4 pieces 68-71 Left 1 piece 72-74 Right 1 piece 72-74	143 845 341 LR 143 845 341 A LR 143 845 341 C LR 143 845 211 BL 143 845 212 BR
<b>2 Outer scraper, pair, 56-59</b> <b>Outer scraper, each, (2 reqd) 60-71</b> <b>Door glass outer scraper, coupe, with chrome trim, 72-74, clips not included</b> Left Right <b>Door glass outer scraper, cabrio, with chrome trim, 72-74, clips not included, left or right</b> <b>Door glass outer scraper, rubber only, 72-74 left/right</b>	141 837 475 A LR 141 837 475 C 141 837 475 D 141 837 476 D 141 837 475 D CAB 141 837 475 D R
<b>3 Outer scraper plastic clips, 72-74, set, 8 pieces</b>	141 837 335 A
<b>4 Door felt inner, 56-74</b>	141 837 479
<b>5 Clip set, for felt guide, 56-74</b>	141 837 487
<b>6 Clips, chrome trim on door top, (10 reqd) 56-71</b> A good cheaper alternative	141 837 335 133 823 717
<b>7 Seal, rear 1/4 window</b> 56-59, non pop-out, pair 60-71, pop-out type, pair 72-74, left or right, includes upright seal	143 847 321 A 143 847 321 BLR 143 847 321 L
<b>8 Seal, rear 1/4 window upright</b> 56-59, Non pop-out type, pair 60-71, Pop-out type, pair	143 847 341 B 143 847 327 LR
<b>9 Seal, roof to moulding, rear 1/4, pair, 60-71</b>	143 847 343 LR
<b>10 Seal, 1/4 post to top, pair, 58-74</b>	143 847 348 LR

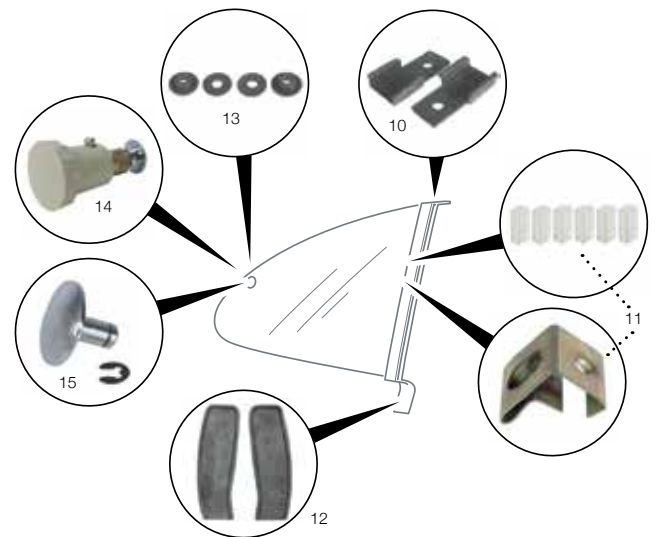

<b>11 Hinge, 1/4 window, (set of 6) 60-74</b> <b>Hinge, 1/4 window, (each) 72-74</b>	143 847 319 LR 143 847 319 ALR
<b>12 Seal, 1/4 post foot, pair 60-74</b>	143 847 349 LR
<b>13 Gasket set, latch to glass, (4 pieces) 60-74</b> <b>Glass anti-rattle bungs, each 56-74, 7 per door from 56-71 and 2 per door 70-74</b>	143 847 320 141 837 491
<b>14 Knob, ivory, pop out windows, each</b>	311-847-245
<b>15 Chrome pin with circlip, window hinge mounts</b>	143-847-005

GLASS & GLASS SETS

All glass is available in grey, green and clear colours - Please call for details.

<b>1 Front windscreen, clear, laminated, 56-74</b>	143 845 101 C
<b>2 Coupe door glass, clear</b> Left, 60-74 Right, 60-74	143 845 201 D 143 845 202 D
<b>3 Coupe rear qtr. Opening glass, clear</b> Left 60-74 Right, 60-74	143 847 041 B 143 847 042 B
<b>4 Coupe rear window glass, clear, heated, 12v, 56-74</b>	143 845 501 B
<b>5 Convertible door glass, clear</b> Left, 57-59 Right, 57-59 Left, 60-74 Right, 60-74	141 845 201 A 141 845 202 A 141 845 201 B 141 845 202 B

Note: when fitting cabrio door glass to pre 8/71 models a modification to the window lifter is required. Call for details.

<b>6 Convertible rear window glass, clear, heated, 12 volt, 69-74</b>	141 845 501 B
---	---------------

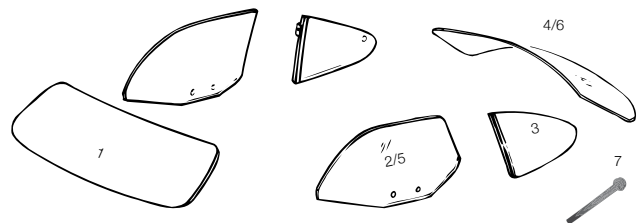

**Heated rear window wiring kit.** Includes wiring kit and switch, 111 898 999 12 volt.  
(This is a WHH kit designed for the Beetle where the battery is located under the rear seat).

<b>7 Grommet, heated rear window, pair</b>	143 971 919
--	-------------



BODY & SCREEN SEALS

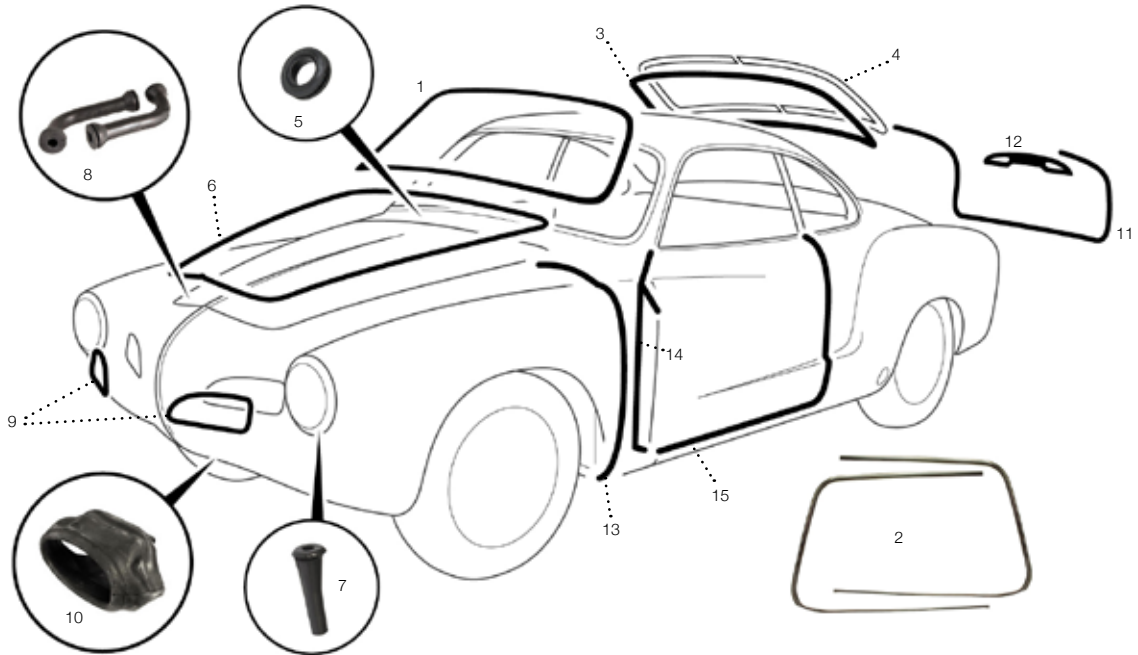

1	<b>Front screen seal</b> , for trim 56-12/65	143 845 121 A
	<b>Front screen seal</b> , for trim 1/66-74	143 845 121 B
	<b>Front screen seal</b> , US models only, for trim 70-74	143 845 121 D
	<b>Front screen seal</b> , no trim 56-74	141 845 121 C
2	<b>Front screen trim</b> , 2 pieces (right & left) 8/67-74	143 853 305/6/A
	<b>Screen seal kit</b> , Cal look, 2 piece, no trim, 63-74	AC831503
3	<b>Rear screen seal</b> , Coupe, for trim, 56-12/65	143 845 521 A
	<b>Rear screen seal</b> , Coupe, for trim, 66-74	143 845 521 B
	<b>Rear screen seal</b> , Coupe, no trim, 56-74	141 845 521 C
	<b>Rear screen seal</b> , Cabrio, 69-74	141 871 521
4	<b>Rear screen trim</b> , 2 pieces (right & left) 8/67-74	143 853 355/6/A
	<b>Clip</b> , for windscreen seal trim (4 req.)	143 853 309 B
5	<b>Wiper shaft seal</b> , 56-69	111 955 261 A
	<b>Wiper shaft seal</b> , 70-74	311 955 261 A

6	<b>Bonnet seal</b> , Original 56-74	141 823 705 A
	<b>Bonnet seal</b> , Reproduction, 56-74	141 823 705 AR
7	<b>Drain tube</b> , Headlight bowl 66-74	141 941 147
8	<b>Drain tube</b> , Bonnet (pair) 56-74	141 823 715
9	<b>Nostril seals</b> , pair 8/59-74	141 853 657 A
10	<b>Horn boot</b> , 56-74	141 951 231
11	<b>Engine lid seal</b> , 56-74	141 827 705 A
12	<b>License plate light gasket</b> , 56-74	143 943 191 L
13	<b>Splash panel seal</b>	143 805 375
14	<b>Hinge pillar weatherstrip</b>	
	Left 56-74	141 831 711 A
	Right 56-74	141 831 712 A
15	<b>Door seal</b>	
	Left, 56-74	141 831 731 C
	Right, 56-74	141 831 732 C

BODY FITTINGS



1	<b>Door scuff plates</b> , pair, 56-65	141 853 370 CLR
	<b>Door striker plate</b> , left, 56-63	141 837 295
	<b>Door striker plate</b> , right, 56-63	141 837 296
	1964-66 not available	
	<b>Door striker plate</b> , left, 67-74	141 837 295 C
	<b>Door striker plate</b> , right, 67-74	141 837 296 C
2	<b>Door check strap</b> , 8/59-74	141 837 253 B
	<b>Door check strap pins</b> , clips, & roller set, per door, 60-74	141 837 256 A
	<b>Door wedges</b> , (2 reqd.) 56-74	141 837 277
	<b>Metal housing</b> , for door wedges, (2 reqd.) 56-74	151 837 289
	<b>Door wedge screw</b> , 56-74	NO1 421 81
	<b>Screw for door wedge metal housing</b> , 56-74	NO1 399 72

3	<b>Engine lid catch</b> , lower, 68-74	141 827 503 B
	<b>Engine lid release cable</b> , 56-74	
	Black knob	143 827 531 B
	White knob	143 827 531 B WH
4	<b>Bonnet catch</b> , upper part, 64-74	321-823-507 A
	<b>Bonnet lid release cable</b> , -67	
	Black knob	143 823 531 B
	White knob	143 823 531 B WH
5	<b>Bonnet release knob</b> , billet aluminium (knob only)	AC8 234 538
	<b>Bonnet release knob</b> , black plastic (knob only)	411 823 665
	<b>Plastic tube</b> (conduit) for engine lid pull 56-74	412 823 557 A

BADGES, GRILLS & EXTERIOR TRIM

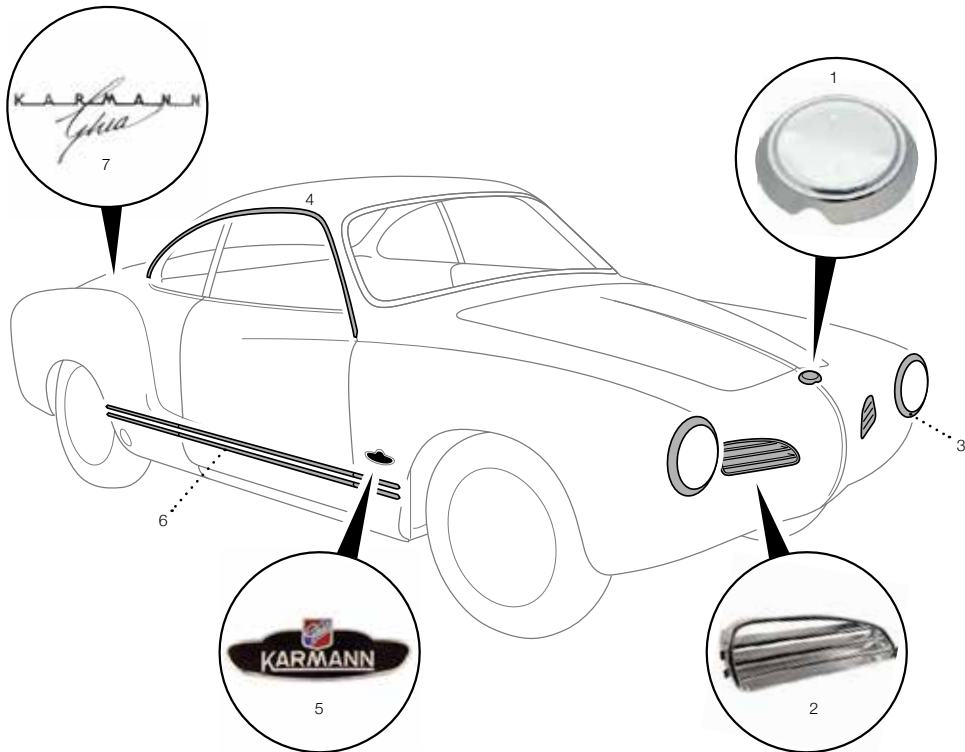

	<b>Nose badge VW, 56-74</b>	141 853 601 B
1	<b>Badge plinth, 56-74</b>	141 853 613
	<b>Badge plinth seal, 56-74</b>	143 853 609
2	<b>Nostril</b>	
	Left, 56-8/59	141 853 651 L
	Right, 56-8/59	141 853 652 R
	Left, 60-74	141 853 651 AL
	Right, 60-74	141 853 652 AR
3	<b>Headlamp trim ring</b>	
	European, 56-74	141 941 177
	US spec, chrome. 64-74	141 941 175 A
	<b>Door scuff plates, pair</b>	
	56-65	141 853 370 C LR
	66-74	141 853 373 C LR

4	<b>Gutter molding, very fragile.</b>	
	Collection only due to size and fragility of part.	
	Left	143 853 421 A
	Right	143 853 422 A
5	<b>Side emblem, enamel, 56-74</b>	141 853 901
	<b>Clips for side emblem (2 reqd.)</b>	113 853 615
6	<b>Chrome body trim, 12 pieces, 56-74</b>	143 898 111 GH I
	<b>Chrome body trim, 12 pieces, stainless steel 56-59</b>	143 898 111
	<b>Chrome body trim, 12 pieces, stainless steel 60-74</b>	143 898 111 A
7	<b>Rear script, 64-74</b>	343 853 905
	<b>Clips for engine lid badge (3 reqd)</b>	171 853 939
	The original and larger Karmann Ghia script (1956-63) are not available. The later script can be used, if you still have the original engine lid, the holes will not line up!	
	<b>Clips for rear script (4 reqd)</b>	113 853 615

MIRRORS



1	<b>Swan neck mirror, L/R 56-64</b>	141 857 197 LR
2	<b>Mirror, 66-74</b>	
	Left	141 857 501 R
	Right	141 857 502 R
3	<b>Mirror base assembly, (inc base seal), 66-74</b>	143 857 000
4	<b>Mirror base seal, 66-74</b>	141 857 511

EXTERIOR DOOR HANDLES



There are differences between door handles from 1956 - '63 and 1964 to '67. Some parts may interchange.

1	<b>Door handle gasket 4 pieces set, 56-67</b>	141 837 240
	<b>Door handle, 68-74</b>	
2	Original quality	113 837 205 M
	Repro	113 837 205 MR
	Repro, pair with matching keys	113 898 205 MG
	<b>Door handle gasket</b>	
3	Small, 2 reqd., 68-74	111 837 209 B
	Large, 2 reqd., 68-74	111 837 211 C



## EXTERIOR ACCESSORIES

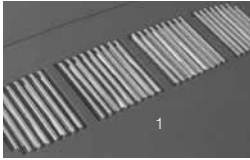

- |   |  |             |
|---|--|-------------|
| 1 | <b>Louvre trim kit</b> , engine lid all years 56-74        | 141 898 100 |
| 2 | <b>Roof rack</b> , vintage speed, wood and stainless steel | AC898091    |
|   | <b>Bra kit</b> , 60-69, heavy duty vinyl                   | AC898531    |

### Karmann Ghia car cover

High quality exterior car cover for outside use. Made from revolution 4 ply material which offers the highest level of protection against all weather conditions. Three outer layers are waterproof and breathable and offer UV protection. The inner layer is a soft non-scratch lining. AC8986403

- |                                |           |
|--------------------------------|-----------|
| <b>Badge</b> , EMPI GTV logo   | AC8536456 |
| <b>Badge</b> , EMPI Globe logo | AC8536455 |

- |  |           |
|--|-----------|
| <b>Number plate surround</b> , US style, front, EMPI | AC8536461 |
| <b>Number plate surround</b> , US style, rear, EMPI  | AC8536460 |

## WINDOW LIFTERS & PARTS



For window winder handles, see the Beetle catalogue.

- |  |               |
|--|---------------|
| <b>Door window regulator</b> , left, 59-67       | 141 837 501 C |
| <b>Door window regulator</b> , right, 59-67      | 141 837 502 C |
| <b>Door window regulator</b> , left, 68-74       | 141 837 501 E |
| <b>Door window regulator</b> , right, 68-74      | 141 837 502 E |
| 1 <b>Lifter channel</b> , coupe or cabrio, 59-74 | 141 837 571 A |
| 2 <b>Spring clip</b> , window lifter, -64        | 111 837 507   |
| <b>Threaded pin</b> for guide channel            | 141 837 563   |

## INTERIOR DOOR HANDLES



For lock pins, please see Beetle catalogue.

### Interior door handles 1956-63

- |   |                                  |                  |
|---|----------------------------------|------------------|
| 1 | Chrome, Brazilian                | 113 837 225 A    |
| 2 | Best quality                     | 113 837 225 AGEN |
|   | <b>Dowel pin</b> for door handle | N01 281 01       |
|   | <b>Trim ring set</b> (4) ivory   | 113 837 235 AIV  |
| 3 | <b>Trim ring set</b> (4) black   | 113 837 235 ABK  |
|   | <b>Trim ring set</b> (2) grey    | 113 837 235 AGY  |
|   | <b>Window winder spring</b>      | 111 837 229 C    |

### Interior door handles 1964-66, 2 piece lever/lock

- |   |   |             |
|---|---|-------------|
| 4 | <b>Trim frame</b>                         | 411 837 097 |
| 5 | <b>Finger plate</b> for trim frame, black | 411 837 095 |

### Interior door handles 1967-70, 1 piece lever

- |   |   |                  |
|---|---|------------------|
|   | Extra value chrome handle kit             | 113 898 237 B    |
| 6 | <b>Lever arm</b> , chrome, left           | 113 837 019 B    |
|   | <b>Lever arm</b> , chrome, right          | 113 837 020 B    |
|   | <b>Trim frame</b> , chrome                | 113 837 239 BCM  |
|   | <b>Trim frame</b> , black                 | 111 837 239 B01C |
|   | <b>Finger plate</b> for trim frame, black | 311 837 247 01C  |
|   | <b>Cone washer</b> for trim frame         | 111 837 291      |

### Interior door handles 1971-74, 2 piece lever/lock

- |   |   |             |
|---|---|-------------|
| 7 | <b>Trim frame</b> , black, pair           | 211 837 097 |
|   | <b>Finger plate</b> for trim frame, black | 411 837 095 |

## CARPET SETS

Our carpet sets are UK made, they are copies of the original carpet and include sewn in rubber mats, heater outlet trim rings (up to 64) and are cloth edged.

Available colours are; Black, Charcoal, Light Grey, Dark Blue, Light Blue, Red, Oatmeal, Green. We are happy to send samples. Once you have placed your order delivery usually takes around 6 weeks.

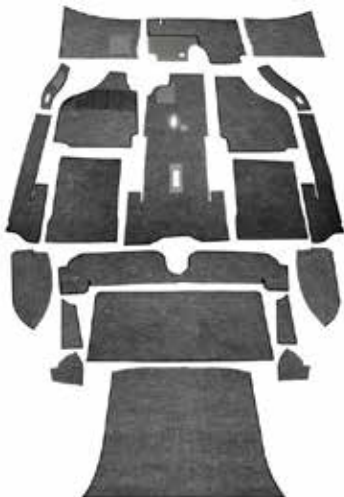

### Coupe carpet sets

- |                        |                 |
|------------------------|-----------------|
| -59, left hand drive   | 143 898 002 L A |
| 59-64, left hand drive | 143 898 002 L B |
| 65-67, left hand drive | 143 898 002 L C |
| 68-69, left hand drive | 143 898 002 L D |
| 1970-, left hand drive | 143 898 002 L E |

- |                         |                 |
|-------------------------|-----------------|
| -59, right hand drive   | 143 898 002 R A |
| 59-64, right hand drive | 143 898 002 R B |
| 65-67, right hand drive | 143 898 002 R C |
| 68-69, right hand drive | 143 898 002 R D |
| 1970-, right hand drive | 143 898 002 R E |

### Cabriolet carpet sets

- |                        |                 |
|------------------------|-----------------|
| -59, left hand drive   | 141 898 002 L A |
| 59-64, left hand drive | 141 898 002 L B |
| 65-67, left hand drive | 141 898 002 L C |
| 68-69, left hand drive | 141 898 002 L D |
| 1970-, left hand drive | 141 898 002 L E |

- |                         |                 |
|-------------------------|-----------------|
| -59, right hand drive   | 141 898 002 R A |
| 59-64, right hand drive | 141 898 002 R B |
| 65-67, right hand drive | 141 898 002 R C |
| 68-69, right hand drive | 141 898 002 R D |
| 1970-, right hand drive | 141 898 002 R E |

- |   |         |
|---|---------|
| <b>4 piece floor mats</b> , no foot rests   | 34M1524 |
| <b>4 piece floor mats</b> , with foot rests | 34M1523 |

HEADLINERS & PARCEL SHELF COVERS

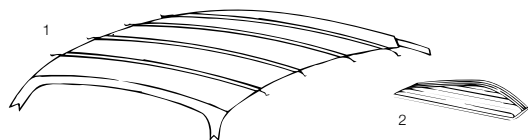

1	<b>Headliner</b> , coupe off-white, original style 56-74 (other colours available - Please call for details, quote part no. 201-510)	143 867 511
2	<b>Parcel shelf cover</b> , plastic (coupe only), 56-74, black	143 867 405 V BK
	<b>Parcel shelf cover</b> , plastic (coupe only), 56-74, white	143 867 405 VWH

SUN VISORS



1	<b>Sun visor</b> , pair, white, 56-8/64	141 857 552 LR
	<b>Sun visor</b> , pair, white, 8/64-74	141 857 552 E LR
	<b>Sun visor</b> , pair, white, 8/64-74, mirror on right visor	141 857 552ELRM
	<b>Sun visor</b> , pair, black, 65-74	211 517
	<b>Sun visor</b> , pair, black, 65-74, with mirror	211 523
	<b>Sun visor clip</b> , pair, 65-74, black	133 857 561 BLK
2	<b>Sun visor clip</b> , pair, 65-74, white	133 857 561 581

BONNET LINERS & FIREWALL



1	<b>Bonnet liner</b> 56-74, black card (stiffer than original) 68-74, grey as original, OE quality with fuel filler cut out & rivets	141 863 509
		141 863 509 B Q
2	<b>Firewall kit</b> Deluxe, 7 pieces, original style Aluminium, 5 pieces, feature bead rolled edge	141 813 805 AA AC 827 3060
3	<b>Wiring cover</b> Molded plastic fits behind the dashboard	AC 937 530
	<b>Screw</b> , for wiring cover, 56-59	113 863 527
	<b>Nut</b> , for wiring cover, 60-69	113 863 527 A

INTERIOR MIRROR / LIGHT



1	<b>Rear view mirror</b> , 68-74, (includes light base)	151 947 131 B
2	<b>Interior light lens</b> , 68-74 <b>Interior light lens</b> , 64-77	151 947 111 C 151 947 111 AR
3	<b>Interior light bulb</b> , 12 volt/5W, 68-74	941 VAG 239

INTERIOR ACCESSORIES

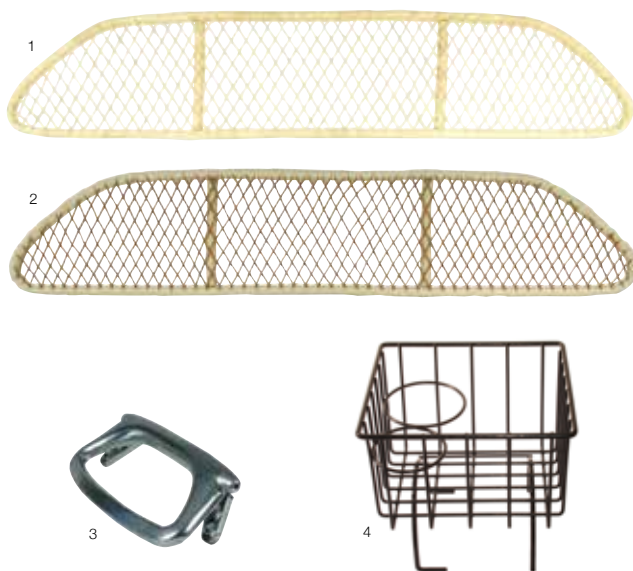

	<b>Parcel shelf</b> , front	
1	Bamboo style	143 857 111 A
2	Bambus style	143 857 111 V
	<b>Fitting kit</b> , parcel shelf	333 301
3	<b>EMPI door pulls</b> , chrome, pair	AC8372080
	<b>Storage basket</b> , tunnel mounted, ivory	AC85705481
	<b>Storage basket</b> , tunnel mounted, chrome	AC85705483
4	<b>Storage basket</b> , tunnel mounted, black	AC85705482
	<b>Centre console</b> , single colour, 68-74	25-1510

DASHBOARD PARTS



1	<b>Dash top cover</b> , LHD, 58-70 <b>Dash top</b> , LHD, cover only, 71-74 <b>Dash top</b> , LHD, 71-74	141 857 681 C 143 857 691 141 857 691 E
	<b>Glove box inner</b> , LHD only, 56-74 <b>Glove box inner</b> , RHD only, 56-74	143 857 101 142 857 101
2	<b>Speaker grille</b> , 56-65 <b>Karmann Ghia script for dashboard</b>	141 857 215 141 853 912
	<b>Shift pattern sticker</b> , ashtray	111 000 000
	<b>Kick pad</b> , lower dash, 2 piece, 68-71	141 857 061 A



## FACTORY FIT SEAT COVERS

Our seat cover sets are manufactured by TMI in the USA using original patterns and original style material. You choose your own seat cover upholstery. There are 3 types of material to choose from. Basket weave, OEM and smooth vinyl. OEM and Smooth Vinyl covers cost the same as each other.

Their prices are listed using the suffix 'OEM' after the part number.

### OEM CLASSIC VINYL

1956-1967, always supplied with off-white piping.

### SMOOTH VINYL

Supplied with matching piping.

### BASKET WEAVE

Supplied with matching smooth vinyl side panels and matching piping.

#### Coupe, seat cover set, front and rear.

56-60	43 1521
61-65	43 1522
66-67	43 1523
68 (USA only)	43 1525
69-71	43 1526
72-74	43 1527

#### Cabrio, seat cover set, front and rear.

57-60	43 1621
61-65	43 1622
66-67	43 1623
68 (USA only)	43 1625
69-71	43 1626
72-74	43 1627

#### Headrest, Coupe and Cabrio.

69-74, pair	43 1530
-------------	---------

Colour swatches can be found on page 18.

For fabric samples please call.

#### Material and colour selection

Each seat cover set has a combined material and colour code. For example; If you have a 69-71 Ghia Coupe (seat cover set 43 1526) and would like basket weave material in brown the code is 02 (see the page 18). Add your chosen code number clearly to the end of your seat cover set part number when ordering. Example: 43 1526 02.

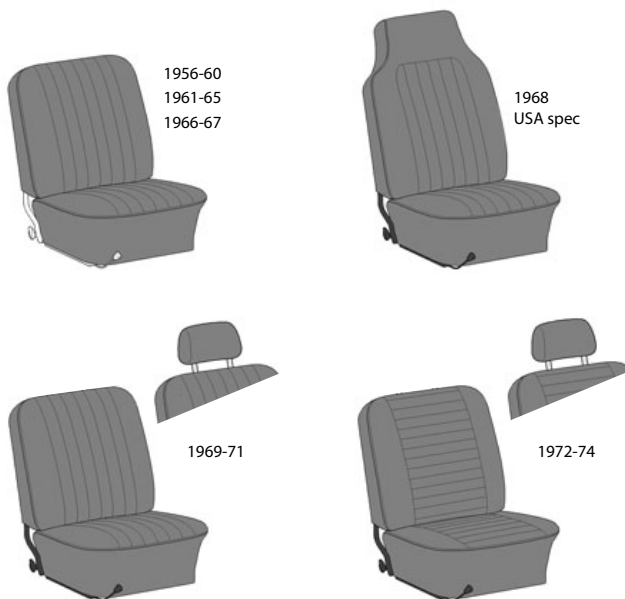

Seat covers and door panels are 'special order items'. Full payment is charged at the point of ordering. Delivery usually takes about 6 weeks from the manufacturer.

## SEAT PADDING

A common mistake is to change the seat covers without repairing or replacing the padding. TMI padding kits make the seats look like new and feel more comfortable. Don't forget to order Sisel - this stops the seat springs eating into your seat padding.

#### Front seat padding

Base, pair, 56-74	43 1500
-------------------	---------

#### Base & backrest, per seat

58-60	43 1514
61-67	43 1515
68, USA ONLY	43 1516
69-74	43 1517

#### Rear seat padding

Rear seat, base & backrest Coupe, 56-74	43 1518
--	---------

#### Seat upholstery accessories

- Hog ring kit. Includes pliers and hog rings 43 4410  
Sisel, felt spring covering, 28 inches x 6 feet 43 4411
- Upholstery buttons. Set of 8, All colours available 43 4414

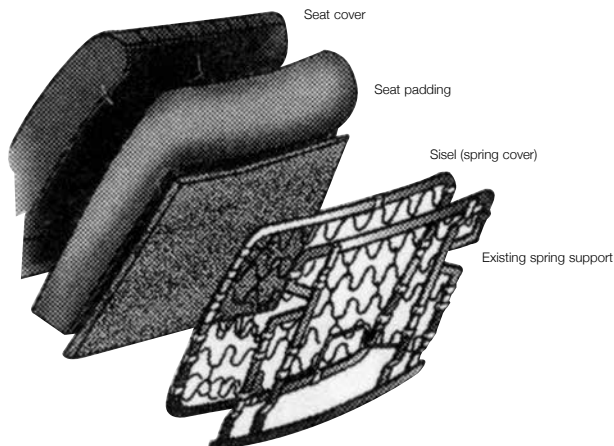

INTERIOR TRIM PANELS

Manufactured by TMI to the same high standard as their seat covers. The trim panels listed here are original type replacements. See page 19 for colour samples.

Original style trim panel sets, with pockets.		
1	Coupe, 4 pieces, 58-63	10 1524
	Coupe, 4 pieces, 64-74	10 1525
	Cabrio, 2 pieces, 58-63	10 1504
	Cabrio, 2 pieces, 64-74	10 1505

Original style trim panel sets, without pockets		
	Coupe, 4 pieces, 58-63	10 1521
	Coupe, 4 pieces, 64-74	10 1522
	Cabrio, 2 pieces, 58-63	10 1501
	Cabrio, 2 pieces, 64-74	10 1502

OEM Classic two-tone trim panel sets, with pockets.		
	Coupe, 4 pieces, 58-63	19 1524
	Coupe, 4 pieces, 64-74	19 1525
	Cabrio, 2 pieces, 58-63	19 1504
	Cabrio, 2 pieces, 64-74	19 1505

Off-white centre strip, matches seat piping on OEM classic seat sets.

2	<b>Door panel clips</b> , (set of 50)	NO1 438 93
3	<b>Door panel bungs</b> , (set of 50)	113 857 219 A
4	<b>Door top cover</b> , black, pair, 8/71-74	141 867 102 LR



5	<b>Rear qtr. cover</b> , black, pair 8/71-74	141 867 103 LR
	<b>Cabrio hinge covers</b> , pair, convertible only 69-74	141 871 198 LR
6	<b>Seal</b> , for interior door handle, foam	171 837 241

**Arm rests** (Arm rests are available in a large range of styles and colours. See Beetle catalogue for details.)

SAFETY & SECURITY

Gear shift lock		
1	Beetles and Ghias, fits all years	113-016-051/C
	Rubber gaiter	141-711-115

**Seat belts**  
We supply a variety of top quality UK made seat belts. All our belts are British Standard approved. Colour options are: - Black, Dark blue, Blue, Cream, Grey, Ivory, Red, Tan  
See page 19 for colour samples.

Inertia seat belts, 3 point.		
	Standard buckle	211-857-691 'Colour'
	Chrome buckle	111 857 691 C 'Colour'

**Static seat belts, 3 point.**



Standard buckle	please call
Chrome buckle	111 857 706 C 'Colour'
Lap belts, static, 2 point.	
Standard buckle	111 857 704 'Colour'
Chrome buckle	111 857 704 C 'Colour'

Exclusive cut away Karmann Ghia A1 size prints.  
Limited to 60 copies, signed by artist.  
Call for details.

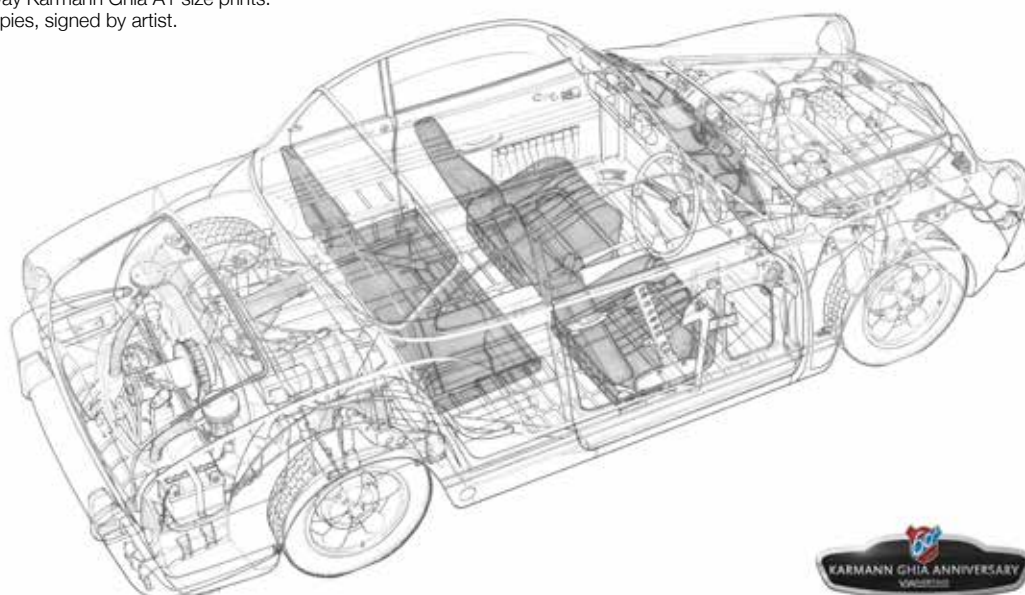

## HOODS, HEADLINERS & PADDING

We supply hoods and hood bags in three different styles. The excellent value TMI vinyl hoods, German original equipment style vinyl and also the very high quality Sonnenland fabric, as used on many new, high specification convertibles. Karmann Ghia Cabrio rear windows made a mid year change from plastic to glass at chassis number 149431007.

<b>1 Hood outer covers - 1957-69</b>	
Vinyl, black, PVC rear window	141-871-038/A
Vinyl, coloured, PVC rear window	141-871-039/A
Heavy duty vinyl, black/coloured, PVC rear window	141-871-038/AV
Sonnenland fabric, black, PVC rear window	141-871-038/AS
Sonnenland fabric, coloured, PVC rear window	141-871-039/AS
<b>2 Hood outer covers - 1969-74</b>	
Vinyl, black, for glass rear window	141-871-038/B
Vinyl, coloured, for glass rear window	141-871-039/B
Heavy duty vinyl, black/coloured, for glass rear window	141-871-038/BG
Heavy duty vinyl, black/coloured, PVC rear window - deletes glass window	141-871-038/BV
Sonnenland fabric, black, for glass rear window	141-871-038/BS
Sonnenland fabric, coloured, for glass rear window	141-871-039/BS
<b>3 Hood bags</b>	
For centre crank mechanism, 1957-69	221627
For J-Hook latches, 1969-74	221627
Pin-point vinyl, 1969-74	141-871-041/LV
Sonnenland fabric, specify colour	141-871-041/LS
<b>Cabrio headliners</b>	
White, 1957-64	141-871-053
German, 1957-64	141-871-053/GER
White, 1965-68	141-871-053/A
German, 1965-68	141-871-053/AGER
White, 1969-74	141-871-053/B
German, 1969-74	141-871-053/BGER
<b>Hood padding sets</b>	
Best quality German, 1957-69	141-871-199/ABQ
3 piece set, 1957-69	141-871-199/A
3 piece set, 1969-74	141-871-199/B

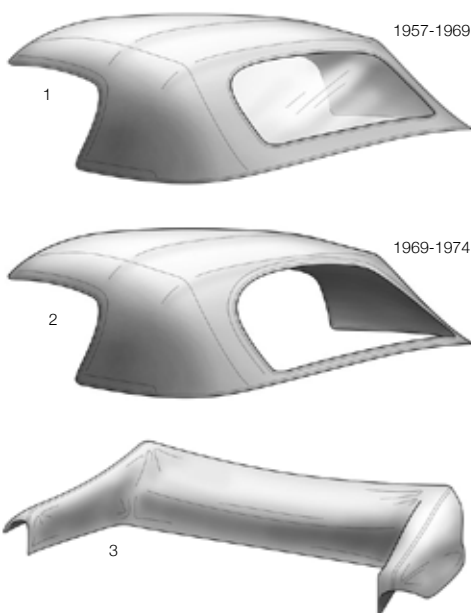

## HOOD PARTS, SEALS & FITTINGS

**Please have your chassis number to hand when enquiring about hoods.**

**Hoods:** The Ghia hood is in 3 parts. Outer cover, inner padding (3 separate pieces) and headliner. The most significant design change was in 1969 when the glass rear window was introduced.

**Quality:** We supply German hoods using the original VW vinyl. Cloth hoods are supplied by the same manufacturer and made from 'Sonnenland material' used on the latest Porsche and Mercedes cabrios. It is guaranteed against fading or stretching and is very strong.

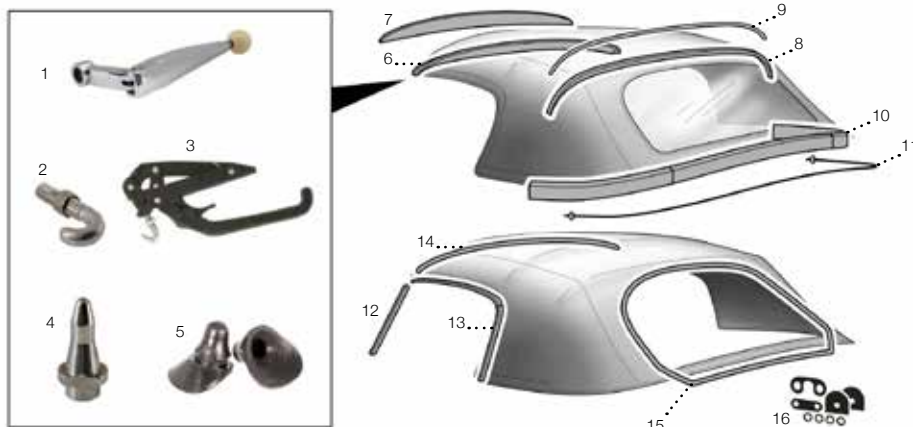

Karmann Ghia Cabrio rear windows made a mid year change from plastic to glass at chassis number 149431007.

<b>1 Roof locking handle</b> , 1958-69	141-871-587
<b>2 Hook</b> for hood clamp 1969-74	155-871-401
<b>3 Hood clamp</b> , upper lock for hood 1969-74	155-871-384/D
<b>Roof locking latch/visor mount</b>	
Left, 1969-74	141-871-385/A
Right, 1969-74	141-871-386/A
<b>4 Hood alignment pin</b> , chrome	141-871-371
<b>5 Bush</b> , for hood alignment pin	151-871-373/A
<b>6 Header bow</b> , wood, fits at the top of the windscreen.	
1957-69	141-871-503
1969-74	141-871-503/A
<b>7 Header bow inside cover</b> , white plastic.	
1957-69	141-871-049/WH
1969-74	141-871-050/WH
<b>8 Wooden bow</b> , fits above the rear window.	
1957-69	141-871-093/A
1969-74	141-871-093/B
<b>9 Chrome trim strip</b> , fits above the rear window, 1957-69.	141-871-999

<b>10 Rear wooden tack strip</b> , 1957-1967. This part was used until mid way through 1967, up to chassis number 147610909. After this date, a tensioning cable was used.	141-871-911/LR
<b>11 Rear hood tensioning wire</b> , 1967-74	141-871-957
<b>Rear window tensioning wire</b> , 1969-74	141-871-959
<b>Side tensioning wire</b> , 1957-74	155-871-971A
<b>12 Screen post to door window seals</b> , pair.	141-871-923/LR
<b>13 Hood frame to door window seals</b> , pair.	141-871-925/ALR
<b>14 Header bow seal</b> , seals front of hood to windscreen frame.	
1957-69	151-871-349/A
1969-74	141-871-609
<b>15 Rear screen seal</b> , 1969-74	141-871-521
<b>16 Seal kit</b> , glass latch, 1969-74	141-871-522
<b>Anti-rattle rubber wedges</b> , rear of door.	141-837-491/LR
<b>Seal</b> , 'flippers', front of rear quarter panel.	141-847-497/LR
<b>Hinge covers</b> , smooth white fibreglass, 1969-74	141-871-198/LR
<b>Press stud cap</b> , Outer, for convertible top cover.	141-871-439/B
<b>Press stud cap</b> , Inner, for convertible top cover.	141-871-440/B



## HEADLIGHTS

There are two variations of headlights, European and US types. Because of the large quantity of rust-free Ghias imported into Europe from the US it is important to know which country your Ghia originally comes from, so we can supply you with the correct headlight.

## EUROPEAN HEADLIGHTS

<b>Headlight unit</b> , Euro spec, RHD, 56-74	142 941 039
<b>Headlight unit</b> , Euro spec, LHD, 60-74	141 941 039/B
<b>1 Glass</b> , for converting European headlight to RHD beam pattern.	142 941 115 A
<b>2 Headlamp trim ring</b> , European, 56-74	141 941 177
<b>3 6 Volt bulb</b> , stnd, 45/40w	941 VAG 423
<b>4 12 Volt bulb</b> , stnd, 45/40w	941 VAG 410
<b>5 6 Volt sidelight bulb</b>	N01 771 71
<b>6 12 Volt sidelight bulb</b>	N01 771 72
<b>7 Headlight to body seal</b> , (2 reqd), 56-74	141 941 191
<b>8 Headlight retaining spring</b> , (6 reqd), 56-74	111 941 125 B
<b>9 Grommet</b> , headlight bowl, 60-65	141 971 907
<b>10 Drain tube</b> , headlight bowl, all models, 8/66-74	141 941 147

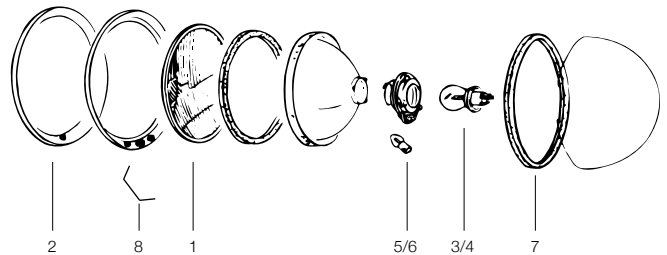

9. Grommet

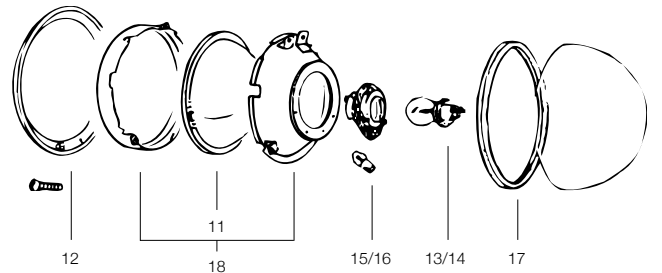

## US HEADLIGHTS

<b>11 Headlight</b> , semi sealed beam unit, US type, H4 bulb	
Left hand drive, 65-74, each	141 941 039 US
Right hand drive, 65-74, curved glass as original, pair	141 941 039 GB
Right hand drive, 65-74, flat glass, each	142 941 039 US
Right hand drive, no side light	142 941 039 GBB
<b>12 Headlamp chrome rim</b> , US spec, 8/64-74	141 941 175 A
<b>3 6 volt bulb</b> , stnd, 45/40W	941 VAG 423
<b>14 12 volt bulb</b> , stnd, 45/40W	941 VAG 410
<b>15 6 volt sidelight bulb</b>	N01 771 71
<b>16 12 volt sidelight bulb</b>	N01 771 72
<b>17 Headlight to body seal</b> , (2 reqd), 56-74	141 941 191
<b>18 Carrier, 67-79</b> (doesn't include item 20)	141 941 041
<b>9 Grommet</b> , headlight bowl, 60-65	141 971 907
<b>10 Drain tube</b> , headlight bowl, all models, 8/66-74	141 941 147

Note: US Ghias have their sidelights wired into the indicators.  
When converting for European regulations, the sidelight wiring is re-routed to the headlight bulb socket.

## FRONT INDICATORS

## 1956 to July 1959

<b>1 Gasket</b> , indicator base to body, (pair), 56-7/59	141 953 165
---	-------------

## August 1959 to December 1963

<b>2 Lens, (pair), 60 -12/63</b>	
Yellow	141 953 161 A
Clear	141 953 161 C
<b>3 Gasket</b> , indicator lens to base, (pair), 60-12/63	141 953 152
<b>4 Bulb, 6V/21W</b>	941 VAG 265
<b>Gasket</b> , indicator base to body, (pair), 60-12/63	141 953 165 A

## January 1964 to August 1969

<b>5 Lens, (pair), 12/63-69</b>	
Yellow	311 953 161
Clear	311 953 161 CL
<b>6 Gasket</b> , indicator lens to base, (pair), 12/63-69	311 953 152
<b>7 6 volt bulb, 21W</b>	941 VAG 317
<b>8 12 volt bulb, 21W</b>	941 VAG 265
<b>9 Gasket</b> , indicator base to body, (pair), 12/63-69	141 953 165 B

## August 1969 to 1974

<b>10 Lens, yellow, 8/69-74</b>	
Left	141 953 161 E
Right	141 953 162 C
<b>11 Bulb, 12V/21W Clear</b>	941 VAG 26
<b>12 Bulb, 12V/21W Amber</b>	941 VAG 265 AMB
<b>13 Gasket</b> , indicator base to body, 8/69-74	
Left	141 953 165 C
Right	141 953 166 C

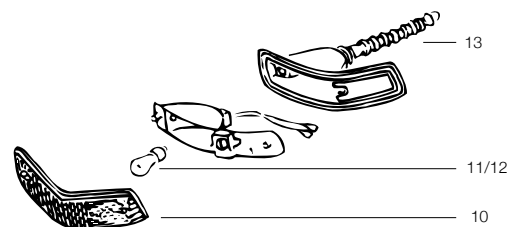
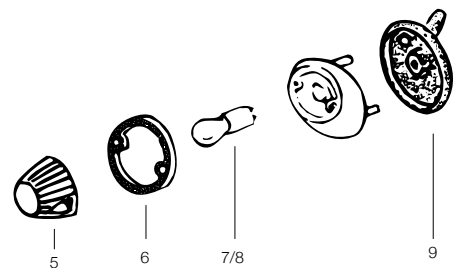
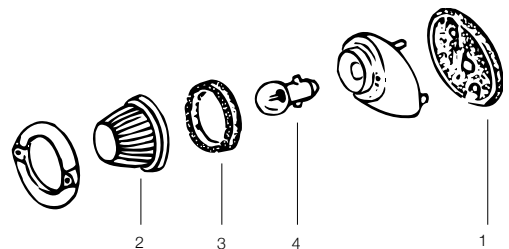

TAIL LIGHTS

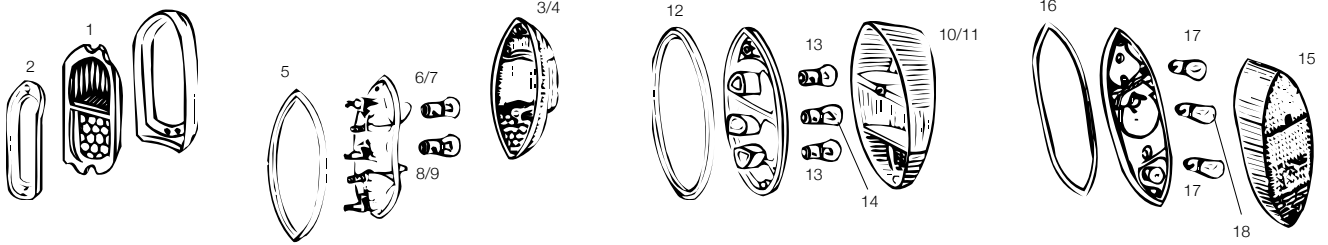

Tail lights for Ghias are now unavailable from Volkswagen. But we supply excellent quality copies at a fraction of the original cost.

<b>1958-1960</b>		
1 Tail light lens, red, 57-60	141 945 227 B	
2 Gasket, tail light, (pair), 57-60	141 945 177 A L/R	
<b>1960-1969</b>		
3 Tail light lens, 60-69 ,red/yellow	141 945 227 E	
4 Tail light lens, 60-69, red	141 945 227 D	
5 Gasket, tail light to body, (pair), 60-69	141 945 177 B L/R	
6 6 volt bulb, indicator/reverse, 21W	941 VAG 317	
7 12 volt bulb, indicator/reverse, 21W	941 VAG 265	
8 6 volt bulb, stop-tail,21W	941 VAG 384	
9 Bulb, stop-tail, 12V 21/5W	941 VAG 380	

<b>1970-1971</b>		
10 Tail light lens, 70-71 red/yellow/white	141 945 227 H	
11 Tail light lens, 70-71 red/white	141 945 227 J	
12 Gasket, tail light to body, (pair), 70-71	141 945 177 C	
13 Bulb, indicator/reverse, 12V/21W	941 VAG 265	
14 Bulb, stop-tail, 12V 21/5W	941 VAG 380	
Reflector, red, US, left or right	141 945 131	
<b>1972-1974</b>		
15 Tail light lens, 72-74, red/yellow/white	311 945 223 P	
16 Gasket, tail light to body, (pair), 72-74	311 945 191 A L/R	
17 Bulb, indicator/reverse, 12V/21W	941 VAG 265	
18 Bulb, stop-tail, 12V 2 1/5W	941 VAG 380	

REAR NUMBER PLATE HOUSING

1 Gasket, number plate light to boot, 56-74	143 943 191L
2 Bulb holder, 58-74	141 943 117 E
3 Lens, No. plate light, (2 reqd) 58-74	141 943 121 A
4 Gasket, No. plate light lens, (pair) 58-74	141 943 131
5 Chrome strip, No. plate, 58-74	141 943 193 A
6 Clip for end chrome strip, (pair), 58-74	141 943 203 A
7 Clip, (Set of 4), 58-74	141 943 195

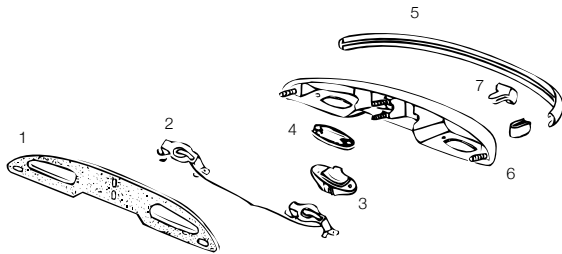

WIRING LOOM

We make our own original style looms for Ghias. Check out our website to see if we have a pattern for your model, if not you will need to send in your original loom for us to copy.

At the time of going to press we can supply a complete loom for 68-69 coupe or convertible 143 971 111/E



TMI VINYLs FOR SEAT COVERS & DOOR PANELS

OEM smooth vinyls



Basket weave vinyls



OEM classic vinyls

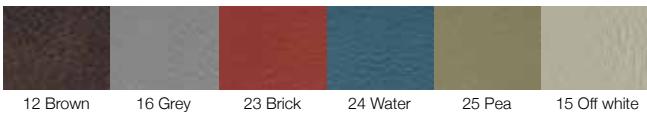

Square weave vinyls

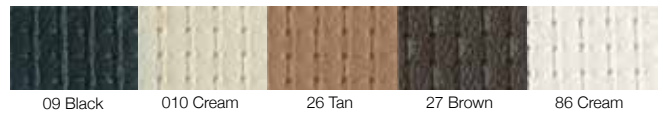

GERMAN HOODS

Sonnenland

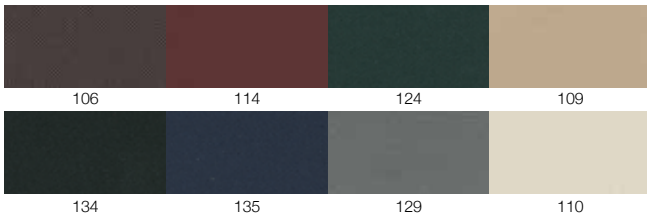

Vinyl

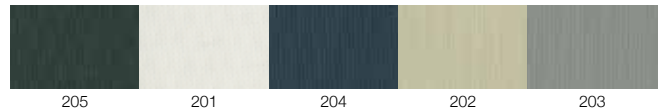

TMI HEADLININGS

Perforated vinyl

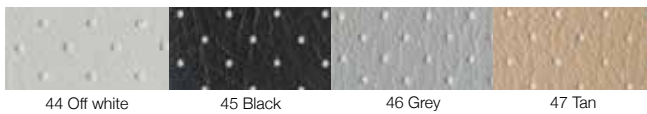

Crush vinyl



Mohair cloth



SEAT BELT SWATCHES



CARPET SET SWATCHES



Carpets (above) are supplied with the corresponding cloth edging (below)

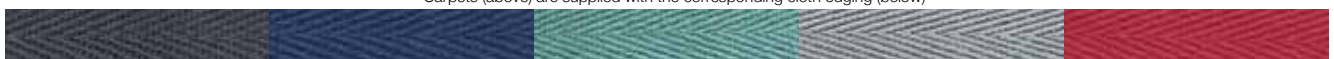

Fabric & cloth also available off the roll. Please call for details.



# vwheritage



ORDER ON THE PHONE  
**01273 444 000**

OVER 17,000 PARTS ONLINE  
**VWHERITAGE.COM**



#### From London or the East:

- Take the M23 south from London until it becomes the A23. As you approach Brighton, turn onto the A27, in the direction of Worthing.
- Exit the A27 onto the A283 to Shoreham and at the roundabout, take the first exit onto Steyning Road.
- At the roundabout, take the first exit onto Upper Shoreham Road. At the supermarket, opposite the park, turn right onto Eastern Avenue.
- Directly before the level crossing, turn left onto Dolphin Road.

#### From the West:

- Exit the A27 onto the A283 to Shoreham and at the roundabout, take the second exit onto Steyning Road.
- At the roundabout, take the first exit onto Upper Shoreham Road. At the supermarket, opposite the park, turn right onto Eastern Avenue.
- Directly before the level crossing, turn left onto Dolphin Road.

**47 DOLPHIN ROAD, SHOREHAM-BY-SEA,  
WEST SUSSEX BN43 6PB  
OVERSEAS TEL. +44 (0) 1273 444 000  
FAX. +44 (0) 1273 454 986**

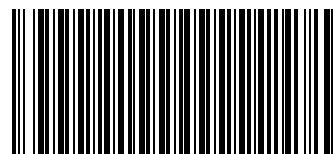

Search for Ghia  
parts on your mobile.